



Repair Options is the aftermarket solution for customers, which is offered by SEM dealers.

Brand new parts, component exchange, overhaul and different repair levels, these are regarded as Repair Options.

Offer broad range of parts and Repair Options to customers. Those are easy to order with a wide coverage, which could help customers maximize the machine value.

BROAD RANGE OF REPAIR OPTIONS

“I want more than just new and like-new options. I want solutions that match my machine life and price point requirement”



SEM SELECT Parts

EXPERT ADVICE & REPAIR

“I want someone to work with me to identify my specific repair needs, then help me understand what options are available to meet them”

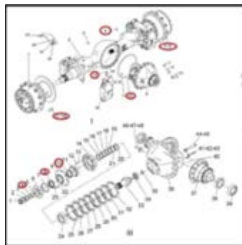

Repair Options Kits



Dealer Rebuild

TIMELY QUOTE & REPAIR

“I want to immediately be advised of price, availability of any alternate parts”



Dealer Components Exchange



New Components

Repair Option Framework

Primary Purchase Driver (s)	OWNERSHIP			
	Uncertain	←	→	Longer
	UTILIZATION			
	Lower	←	→	Higher
	PRICE			
	Sensitive	←	→	Prefers Guaranteed
	TURN/AROUND			
	Flexible	←	→	Fast
Attributes	<ul style="list-style-type: none"><li>• Extends life</li><li>• Before Failure</li><li>• 100% New Parts Replacement</li><li>• Lower Cost</li></ul>	<ul style="list-style-type: none"><li>•Extends life</li><li>•Before Failure</li><li>•Lower Cost</li></ul>	<ul style="list-style-type: none"><li>• Before or After Failure</li><li>• Immediate availability for exchange</li></ul>	<ul style="list-style-type: none"><li>• After Failure</li><li>• Immediate availability</li></ul>
Target Price Point Relative to Factory New	< 30%	20 – 50%	40 – 70%	100%
		Enhanced reuse & salvage results in lower price point.		
Possible Repair Options offer	Level 1 Reseal & Rebearing	Level 2 Reseal & Rebearing Plus	Level 3 Overhaul/Exchange	Level 4 New
Product	<ul style="list-style-type: none"><li>• Includes bearings, seals, gaskets and normal one-life “wear” parts.</li><li>• Paper or Stock Kits Offering</li></ul>	<ul style="list-style-type: none"><li>• Includes all Level 1 parts</li><li>• Replaces or Reconditions other critical parts</li><li>• Customer can specify additional parts</li></ul>	<ul style="list-style-type: none"><li>• Dealer Rebuild, Dealer floating components</li><li>• Including All Level 1 parts.</li><li>• All parts are inspected</li></ul>	<ul style="list-style-type: none"><li>• New components Replacement</li><li>• Reset Component Hours to Zero</li></ul>







## Advantages For Customers

- Improved speed and convenience by being able to order and receive all at once the most common wear items needed to complete the repair job.
- Protects and extends the life of major components by replacing inexpensive wear parts.
- Allows you to schedule downtime, and plan for maintenance and repair costs.

## Repair Option Classification

### Real Kit

- ✓ It is an orderable and serviceable part number with a HTS code, all China and International customers can place order in DCP or Antares, this kit is much easier to own for customers, such as Seal kit

### Paper Kit

- ! Paper kit is not serviceable, but it is consisting of several individual service parts for repair/service. Dealer should order the sub-level service parts. Detailed sub-level service parts list can be viewed in DCP, such as Repair kit, PM kit, Mid-life repair kit, Overhaul repair kit.



**More Repair Options are under development, if you have further questions, please contact your regional Aftermarket Service Representatives.**





ENGINE ESTIMATED OVERHAUL TIME

20

HOURS

Engine Target remove & install

76

HOURS

Engine Target overhaul time

10K

HOURS

Engine Target overhaul SMU\*

\*Actual optimum hours may be approximately 2,000 higher/lower depending on maintenance practices and application.

CONFIGURE YOUR REBUILD & CHECK PRICING

- 1 Consult with your local dealer to choose the most suitable repair option.
- 2 Select from the recommended parts lists or kits on the following pages
- 3 Check pricing and availability with your local dealer



Sales Model	Engine KITS								
	Engine arrangement	Real kits						Paper kit	
		Cyl Head (CH) seal kit	Front Structure(FS) Seal Kit	Oil Cooler and Lines (OCL) Seal Kit	Rear Structure (RS) Seal Kit	Intake and exhaust system seal kit	Piston & Liner Reapir Kit	Mid-life repair kits	Overhaul repair kits
655D/656D	5534582(T2)	6022082	6022087	6022089	6022084	6022079	6022076	SE_P5534582KIT02	SE_P5534582KIT03
655D/656D	6123193(T2)	6022082	6022087	6022089	6022084	6022079	6022076	SE_P6123193KIT02	SE_P6123193KIT03
656D	5384501(BS III )	6022093	6022094	6022089	6022084	6022090	6022078	SE_P5384501KIT02	SE_P5384501KIT03
656D	5847657 Brazil T3	6022093	6022094	6022089	6022084	6022090	6022078	SE_P5847657KIT02	SE_P5847657KIT03

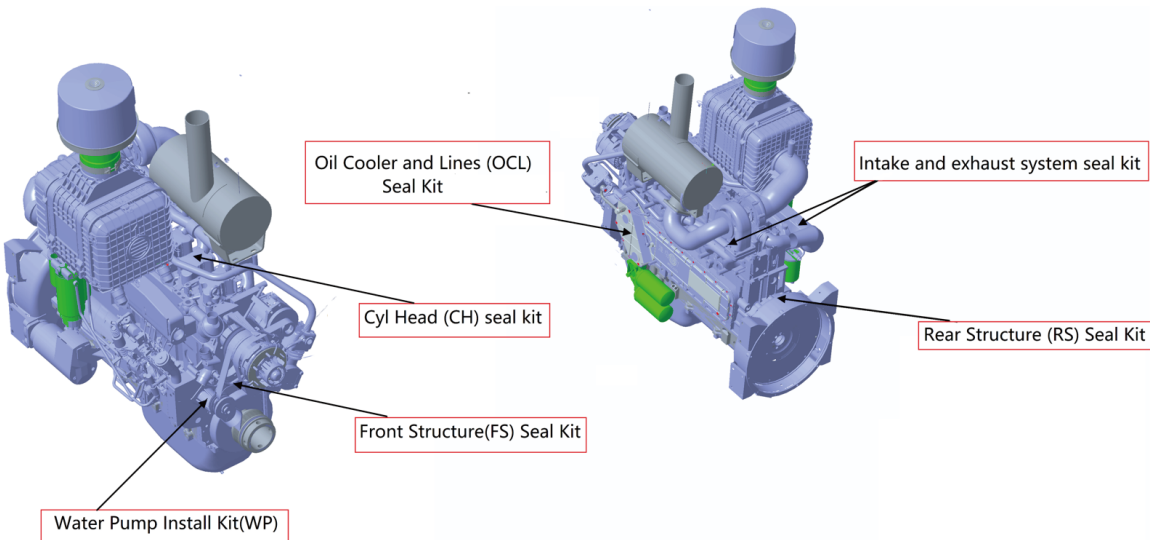

Mid-life Repair Kits Consist

- LINER
- PISTON
- PIN-PISTON
- RTNR-PIN
- RING-PISTON
- SEAT
- VALVE
- BRDG-VALVE
- RETAINER
- SPRING
- GUIDE
- INJECTOR GP
- GASKET/ SEAL
- HOSE

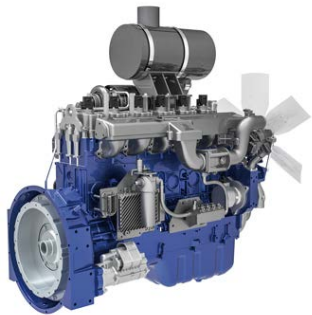

Overhaul Repair Kits Consist

- LINER
- PISTON
- PIN-PISTON
- RTNR-PIN
- RING-PISTON
- SEAT
- VALVE
- BRDG-VALVE
- RETAINER
- SPRING
- GUIDE
- INJECTOR GP
- GASKET
- SEAL
- HOSE
- PUSHROD AS
- TAPPET
- ROD GP
- BEARING
- RGLTR AS
- OIL PUMP GP
- SENSOR AS
- TURBOCHARGER
- WATER PUMP GP
- THERMOSTAT
- CORE-OIL COOLER
- TURBOCHARGER BOLT
- STUD
- CYLINDER HEAD BOLT



XMSN ESTIMATED OVERHAUL TIME

17

HOURS

XMSN Target remove & install

56

HOURS

XMSN Target overhaul time

10K

HOURS

XMSN Target overhaul SMU\*

\*Actual optimum hours may be approximately 2,000 higher/lower depending on maintenance practices and application.

CONFIGURE YOUR REBUILD & CHECK PRICING

- 1 Consult with your local dealer to choose the most suitable repair option.
- 2 Select from the recommended parts lists or kits on the following pages
- 3 Check pricing and availability with your local dealer



Sales Model	TRANSMISSION KITS								
	Transmisson arrangement	Real kits						Paper kit	
		Bearing kits -Input shaft	Bearing kits -2&4 clutch	Bearing kits -1&3 clutch	Seal kits -Piston	Seal kits -XMSN	Retainer kits	Mid-life repair kits	Overhaul repair kits
655D	5249250	6006768	6006769	6006770	5998123	5998125	5998124	SE_P6366967	SE_P6366973
655D	6070008	6006768	6006769	6006770	5998123	5998125	5998124	SE_P6366968	SE_P6366974
656D	5249246	6006768	6006769	6006770	5998123	5998125	5998124	SE_P6366969	SE_P6366975
656D	6070009	6006768	6006769	6006770	5998123	5998125	5998124	SE_P6366970	SE_P6366978
656D	6070010	6006768	6006769	6006770	5998123	5998125	5998124	SE_P6366982	SE_P6366988

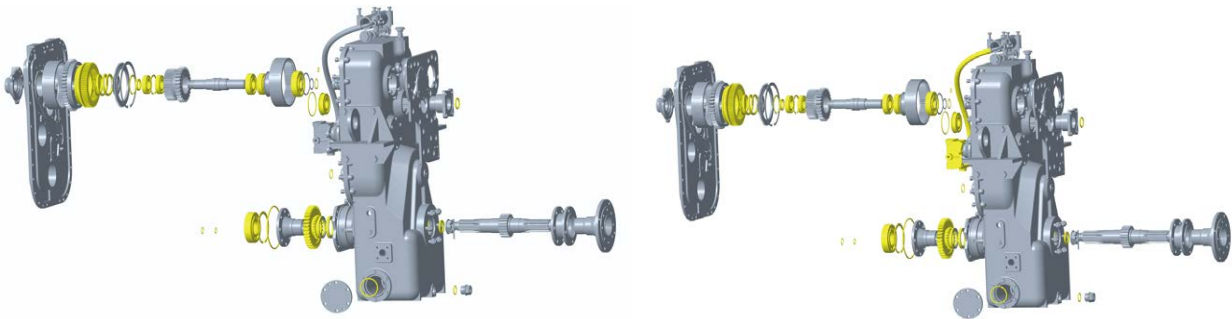

XMSN Mid-life Repair Kits Consist

- Seals
- Retainers
- Bearings
- Pistons/piston rings
- Sleeves
- Friction Discs
- Springs
- Gears
- Filters/Strainer
- Washers/Gaskets

XMSN Overhaul Repair Kits Consist

- Seals
- Retainers
- Bearings
- Pistons/piston rings
- Sleeves
- Friction Discs
- Springs
- Gears
- Filters/Strainer
- Washers/Gaskets
- Hoses
- Valves
- Brake



# TORQUE CONVERTOR ESTIMATED OVERHAUL TIME

20  
HOURS

TC Target remove & install

22  
HOURS

TC Target overhaul time

10K  
HOURS

TC Target overhaul SMU\*

\*Actual optimum hours may be approximately 2,000 higher/lower depending on maintenance practices and application.

## CONFIGURE YOUR REBUILD & CHECK PRICING

- 1 Consult with your local dealer to choose the most suitable repair option.
- 2 Select from the recommended parts lists or kits on the following pages
- 3 Check pricing and availability with your local dealer



## TORQUE CONVERTER KITS

Sales Model	TORQUE CONVERTER KITS		
	Torque convertor arrangement	Real kits	Paper kit
		Cyl Head (CH) seal kit	Overhaul repair kits
655D	5533497	6306560	SE_P6367002
656D	5225138	6306560	SE_P6366980
656D	6004785	6306560	SE_P6366981

## TC Overhaul Repair Kits

- Seals
- Retainers
- Washers/Gaskets
- Bearings
- Gears
- Sleeves
- Valves
- Turbine/Impeller/Idler

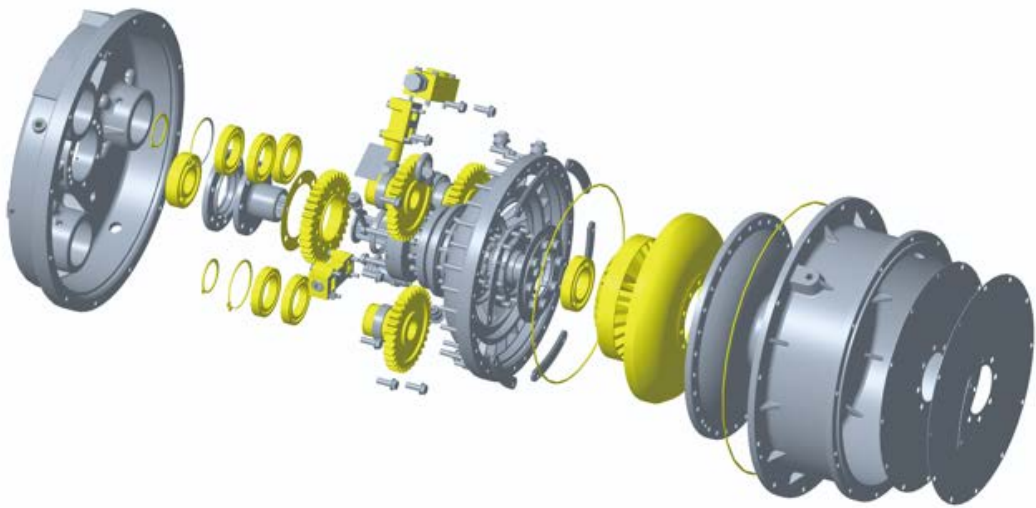



AXLE ESTIMATED OVERHAUL TIME

10

HOURS

Axle Target  
remove & install

44

HOURS

Axle Target  
overhaul time

6K

HOURS

Axle Target  
overhaul SMU\*

\*Actual optimum hours may be approximately 2,000 higher/lower depending on maintenance practices and application.

CONFIGURE YOUR REBUILD & CHECK PRICING

- 1
- Consult with your local dealer to choose the most suitable repair option.
- 2
- Select from the recommended parts lists or kits on the following pages
- 3
- Check pricing and availability with your local dealer



Sales Model	AXLE KITS													
	Axle arrangement	Axle seal kits	Reducer kits				End Wheel Kits			Brake kits			Mid-life repair kits	Overhaul repair kits
			Reducer GP	Reducer seal kit	Reducer shim kit	Reducer bearing kit	Wheel end GP	Wheel end shim kit	Wheel end bearing kit	Brake GP	Brake seal kits	Brake caliper repair kits		
655D/656D	5889501	6364292	5224345	6199479	6199480	SE_PA11111124	SE_P5387562	N/A	SE_PA11111126	5364782	6022106	SE_PA00000013	SE_PA11111119	SE_PA11111111
655D/656D	5889497	6364293	5224378	6199479	6199480	SE_PA11111124	SE_P5224381	N/A	SE_PA11111127	5364782	6022106	SE_PA00000013	SE_PA11111120	SE_PA11111115
655D/656D	5889498	6364293	5224378	6199479	6199480	SE_PA11111124	SE_P5224381	N/A	SE_PA11111127	5364782	6022106	SE_PA00000013	SE_PA11111120	SE_PA11111115
655D/656D	5387552	6364300	5225741	6199479	6199480	SE_PA11111124	5387555	6364301	SE_PA11111126	5364782	6022106	SE_PA00000013	SE_PA11111123	SE_PA11111114
655D/656D	5387556	6364300	5225743	6199479	6199480	SE_PA11111124	5387555	6364301	SE_PA11111126	5364782	6022106	SE_PA00000013	SE_PA11111123	SE_PA11111118
656D	5891212	6364300	5225743	6199479	6199480	SE_PA11111124	5387555	6364301	SE_PA11111126	5364782	6022106	SE_PA00000013	SE_PA11111123	SE_PA11111118

Arrangement/Group parts   Real Kit   Paper Kit

Axle Overhaul Repair Kits Consist

- Seals
- Spacers
- Retainers
- Washers/Shims
- Planetary gear shaft/Shaft
- Gears
- Nozzle/Nozzle Seat
- Piston
- Brake discs
- Needles
- Nuts-Differential

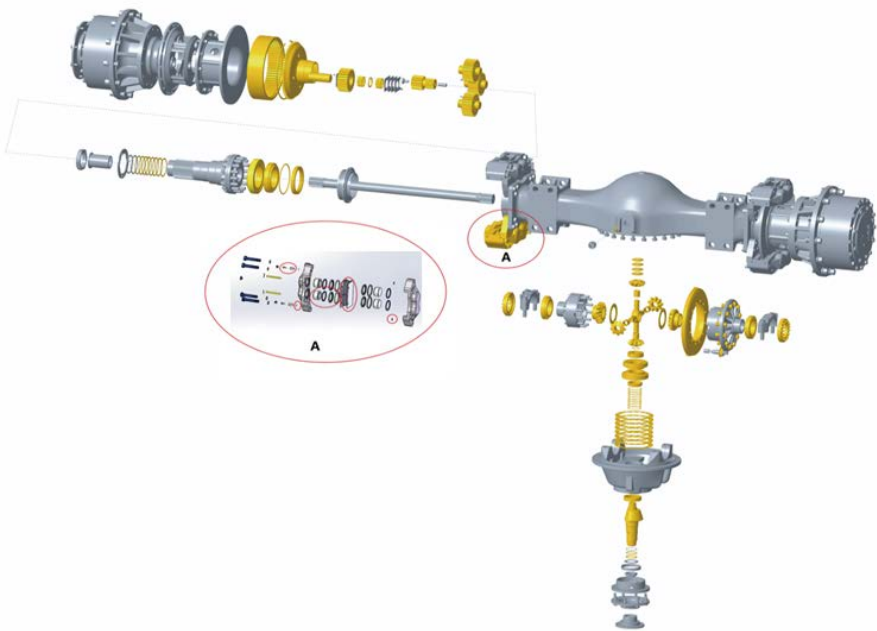

# **SEMPARTS**

## ***Matched to your needs***



**Caterpillar (Qingzhou) Ltd. Address: No. 12999 Nanhuan Road, Qingzhou City, Shandong Province, Zip Code: 262500, P.R.China**

© 2025 Caterpillar (Qingzhou) Ltd. All Rights Reserved. 山工机械, SEM, SEM Logo, their respective logos, trade dress as well as corporate and product identity used herein, are trademarks of Caterpillar (Qingzhou) Ltd. and may not be used without permission.

Materials and specifications are subject to change without notice. Featured machines in photos may include optional equipment. Contact your SEM dealer for available options.

Version: May 2025